

SERIES R25

Harowe™ brand

Heavy Duty Resolver

Key Features

- Rugged Housing with IP65 Rating
- Spaced Bearings for up to 10x the Life of Traditional Duplex Bearings
- Withstands 200g Shock and 40g Vibration



Most Models

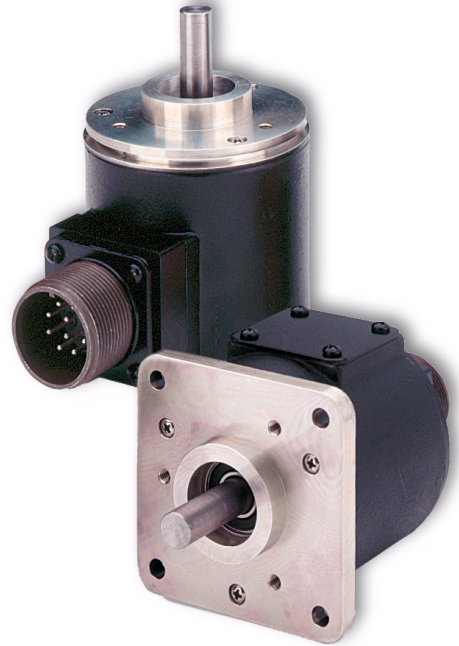

SPECIFICATIONS

STANDARD OPERATING CHARACTERISTICS

Electrical Kit	Speed (Number of Poles)	Transformer Ratio (V in/V out)	Input Voltage (Vrms)	Max. Current Input (mA)	Reference Frequency (Hz)	Phase Shift (nominal)	Primary Winding
1A	1 (2)	0.500	5.3	3	4000	-3	Stator
1B	1 (2)	0.500	4.0	25	5000	-6	Rotor
1C	1 (2)	0.470	4.25	55	7000	+4	Rotor
1D	1 (2)	0.500	7.0	25	2500	+6	Rotor
1E	1 (2)	0.950	7.0	12	5000	-8	Rotor
1F	1 (2)	1.000	2.0	10	5000	-8	Rotor
1H	1 (2)	1.069	8	17	2600	8	Rotor
1J	1 (2)	0.454	26	22	2400	6	Rotor
1K	1 (2)	0.454	26	65	2400	8	Rotor
1M *	1 (2)	0.5	4	25	5000	-6	Rotor
2A	2 (4)	0.250	8.0	20	4000	+5.5	Rotor
3A	3 (6)	0.470	4.25	55	7000	+5.5	Rotor
3B	3 (6)	0.95	7	12	5000	4	Rotor

*Radiation Hardened

MECHANICAL

- Inertia:** 0.0040 oz-in-sec²
- Friction:** 2 oz-in (5 oz-in w/shaft seal)
- Shaft Load: (max.)** 40 lb (axial), 60 lb (radial)
- Shaft Material:** #416 S/S
- Play: (max.)** Radial: .0015 in @ 1 lb load; End: .005 in @ 5 lb load
- Bearing Life:** 2 x 10⁸ revs at rated shaft loading

ELECTRICAL CONNECTIONS

Connector: MS3106F-	16S-1S	18-1S	
Signal	Pin	Pin	Cable Color
R1 (Rotor Hi)	A	A	White
R2 (Rotor Lo)	B	H	Black w/White
S1 (Cos Hi)	C	B	Green
S3 (Cos Lo)	D	I	Black w/Green
S4 (Sin Lo)	F	C	Blue
S2 (Sin Hi)	E	J	Black w/Blue
N/C	G	G	—

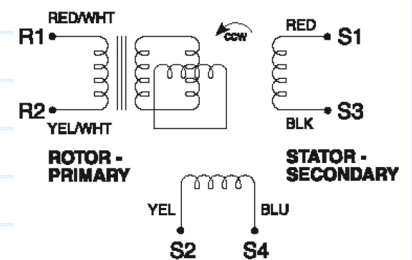

Ordering Information

To order, complete the model number with code numbers from the table below:

Code 1: Model	Code 2: Mounting	Code 3: Connector Type	Code 4: Conn. Exit	Code 5: Shaft	Code 6: Seal	Code 7: Elec. Parts Kit	Code 8: Accuracy	Code 9: Special
R25	<input type="checkbox"/>	<input type="checkbox"/>	<input type="checkbox"/>	<input type="checkbox"/>	<input type="checkbox"/>	<input type="checkbox"/>	<input type="checkbox"/>	<input checked="" type="checkbox"/> <input checked="" type="checkbox"/>
Ordering Information								
R25 Heavy-duty, resolver	F Flange	B MS3102E-16S-1P	R Rear Exit	R Round	Y Shaft Seal	Available when Code 8 is 07 to 20	02 2 arc min	00 Factory Assigned Designator
	S Servo	C MS3102E-18-1P	S Side Exit	F Round with flat	N No Shaft Seal	Available when Code 8 is 04 to 10	03 3 arc min	
		F FLYING LEADS	G MS3112E-10-6P		W Round with 2 flats @ 90 degrees	Available when Code 8 is 02 to 10	04 4 arc min	
		L MS3112-18-11P				1A 1E 1J	05 5 arc min	
		P PT02E-14-19-P				1B 1F 1K	07 7 arc min	
						1C 1H 1M	10 10 arc min	
						1D	2S 20 arc min Spread	
						2A	15 15 arc min	
						3A 3B	20 20 arc min	

DIMENSIONS inches [mm]

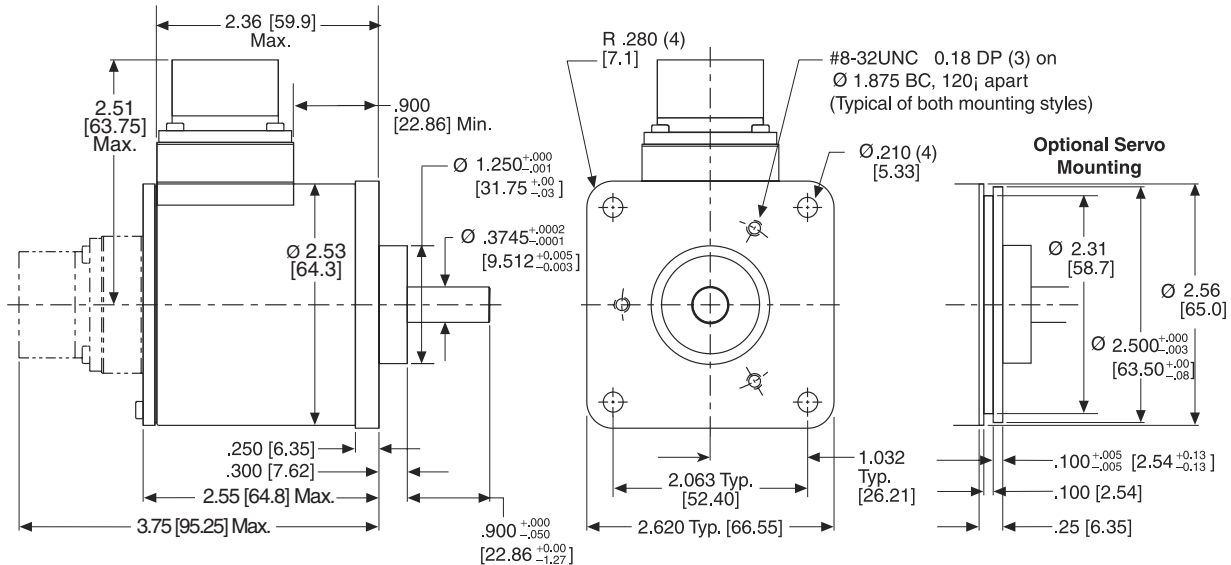

Note: Dimensions are dependent on Connector type - Shown with B = MS3102E-16S-1P

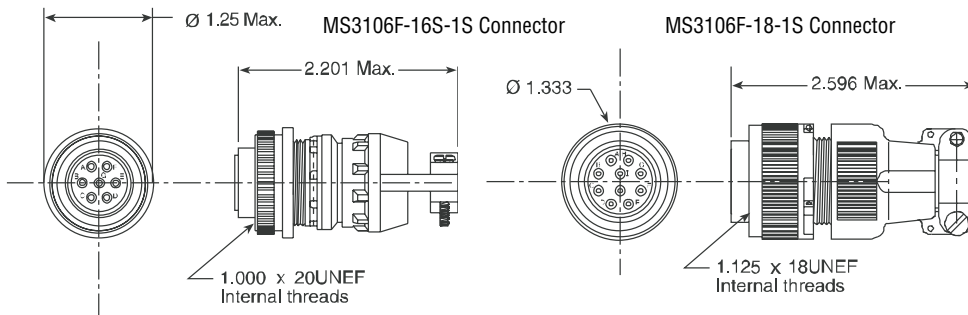

Accessories:
CA-18-R-0010 10 ft.cable with MS3106F-18-1S Connector
CA-16-R-0010 10 ft.cable with MS3106F-16S-1S Connector
Note: Part numbers listed with -0010 are for 10 Foot Cable; use -0050 for 50 Foot Cable, etc



Satellite Locations:

- **North America:** North Carolina, South Carolina, Connecticut, Massachusetts, New York, Canada, British Virgin Islands
- **West Indies:** St. Kitts • **Europe:** United Kingdom, Italy, France, Germany, Spain, Slovakia
- **South America:** Brazil • **Asia:** China, Japan, Korea, Singapore

Worldwide Brands: NorthStar™ • Acuro™ • Dynapar™ • Hengstler™ • Harowe™

Headquarters: 1675 Delany Road • Gurnee, IL 60031-1282 • USA • Phone: 1.847.662.2666 • Fax: 1.847.662.6633

Customer Service:

Tel.: +1.800.873.8731
 Fax: +1.847.662.4150
 custserv@dynapar.com

Technical Support

Tel.: +1.800.234.8731
 Fax: +1.847.782.5277
 dynapar.techsupport@dynapar.com